

PLAN

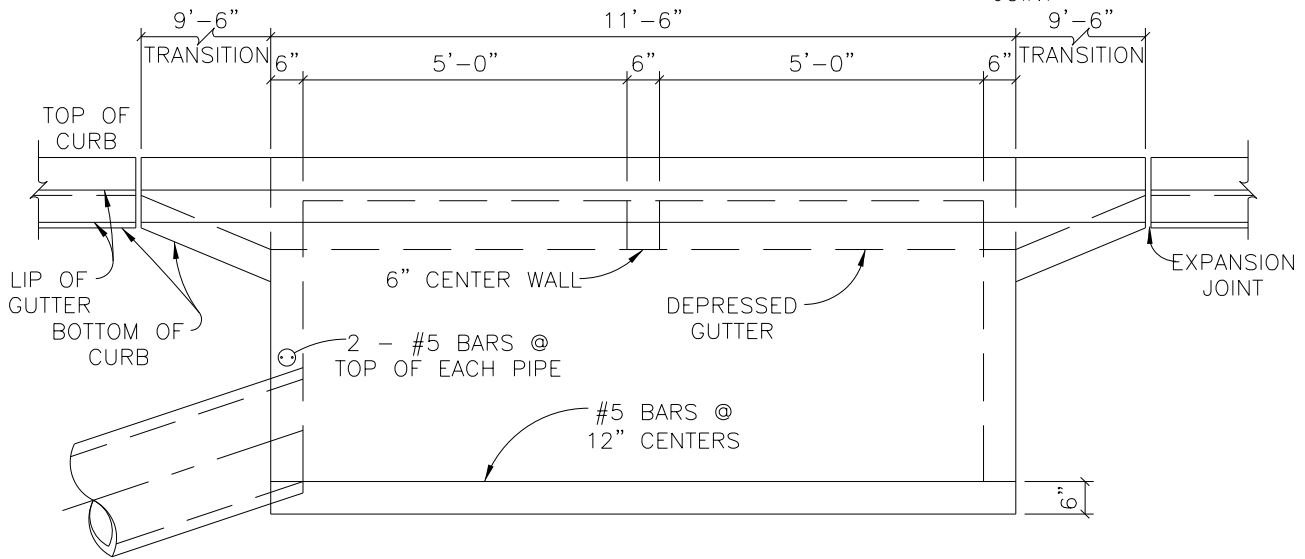

FRONT ELEVATION

NOTES:

1. ALL CONCRETE SHALL BE MINIMUM 5 SACK CONCRETE WITH A 28 DAY COMPRESSIVE STRENGTH OF CLASS A MINIMUM.
2. STORM SEWER PIPE MATERIAL TO BE AS INDICATED IN THE CONTRACT DOCUMENTS.
3. AT INLETS WHERE MULTIPLE PIPES ARE CONNECTED, THE INVERT SHALL BE GROUTED AND SHAPED AS REQUIRED TO PROVIDE AN EFFICIENT FLOW PATH FOR EACH PIPE.
4. WHERE AN INLET HAS MULTIPLE PIPES, ALIGN FLOW DIRECTIONS AS CLOSELY AS POSSIBLE TO MINIMIZE DIRECTIONAL CHANGES.

SCALE: NOT TO SCALE



MARBLE FALLS
 800 THIRD STREET
 MARBLE FALLS, TX 78654
 PH: (830) 693-6737

These documents were prepared by,
 or under the supervision of:

ERIC BELAJ 107148 May 31, 2017
 Engineer's Name PE# Date

[Signature]
 Engineer's Signature

SECTION
STORM DRAINAGE

DETAIL NO.
 SD-1

TITLE
 STANDARD CURB INLET